

existing steel and concrete staircase to be relocated from existing position, stairs to be cut off at ground and landing level supported on re mounted to floor and new mezzanines. Allow for new spreader plate to support steel and fixings to floor see structural engineers drawings (note restricted fixing depth allow to break out floor so fixing do not interfere with heating pipes)

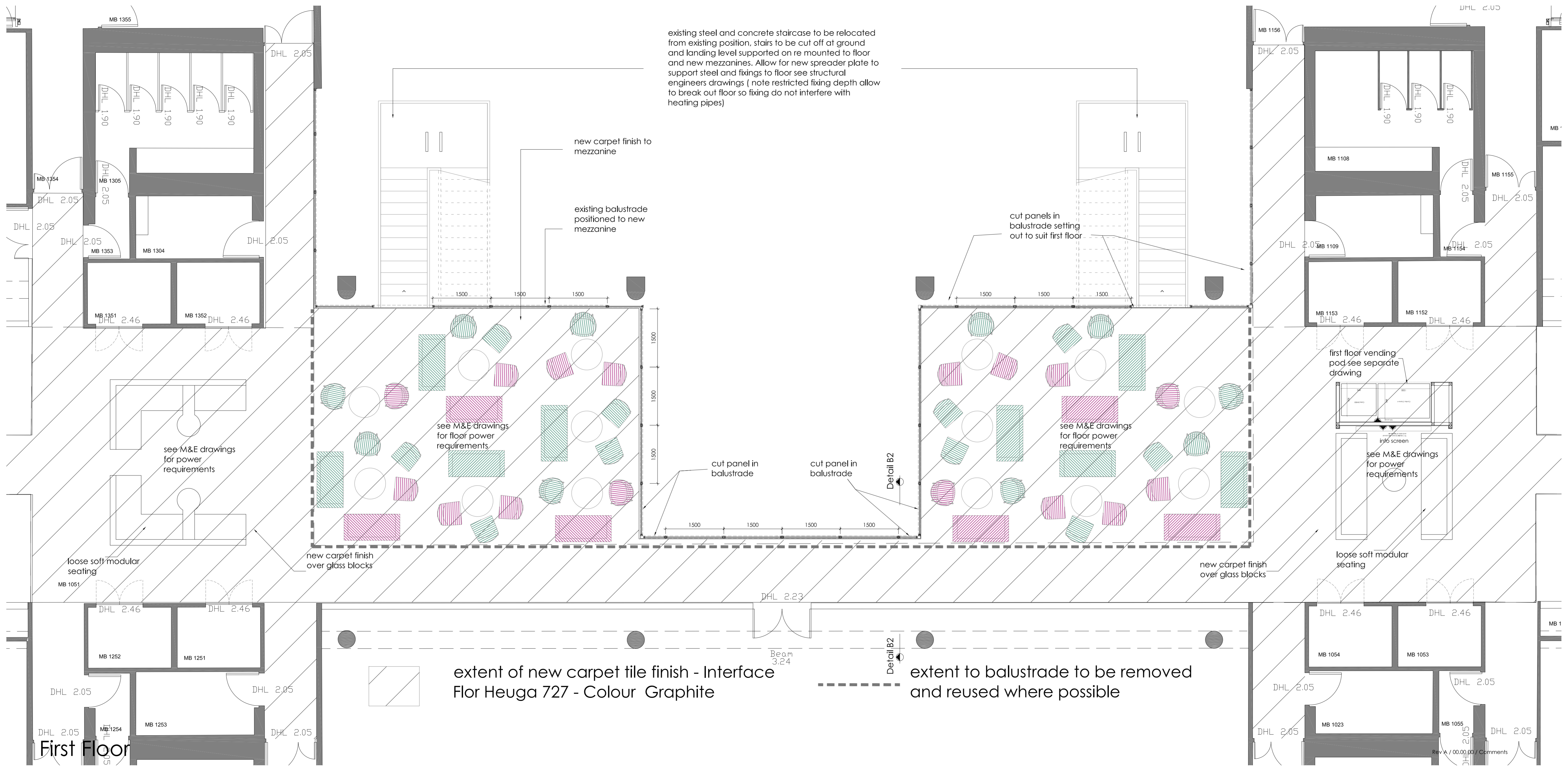

new carpet finish to mezzanine

existing balustrade positioned to new mezzanine

cut panels in balustrade setting out to suit first floor

cut panel in balustrade

cut panel in balustrade

Detail B2

first floor vending pod see separate drawing

see M&E drawings for power requirements

loose soft modular seating

extent of new carpet tile finish - Interface Flor Heuga 727 - Colour Graphite

extent to balustrade to be removed and reused where possible

First Floor